

# CSA certified, hermetic triaxial accelerometer 993B-7-33

## Key features

- Rugged hermetic design
- General purpose
- Broad frequency response
- Easy to mount
- EMI/RFI protection
- ESD protection
- Reverse wiring protection
- Low noise
- Low weight
- Hazardous area certified - intrinsically safe
- Manufactured in an approved ISO 9001 facility

## Certifications



Class I Div 1 Groups A, B, C, D,  
T4 (85°C Max)

For hazardous area locations, sensor must be installed in accordance with installation instructions or local code requirements. Electrical safety barrier required for hazardous area installations.

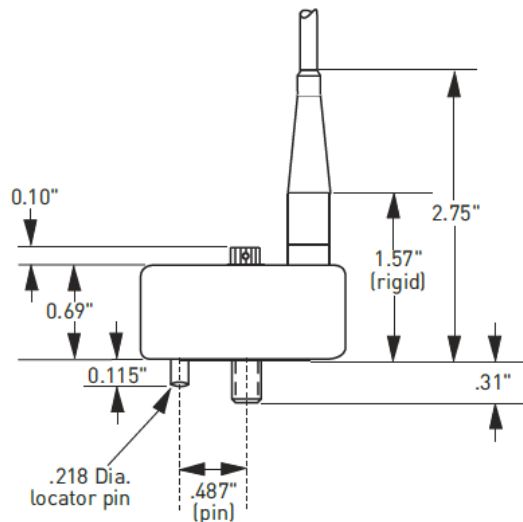
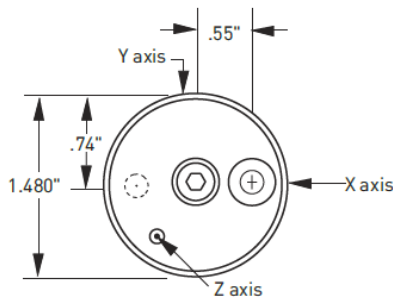

Connections	
Function	Cable conductor color
X axis, power/signal	green
Y axis, power/signal	red
Z axis, power/signal	white
common (all channels)	black
N/C	shield

Note: Due to continuous process improvement, specifications are subject to change without notice.  
This document is cleared for public release.

Wilcoxon Sensing Technologies  
20511 Seneca Meadows Parkway  
Germantown, MD 20876  
info@wilcoxon.com

Tel: (301) 330 8811  
Fax: (301) 330 8873  
www.wilcoxon.com

Wilcoxon Sensing Technologies  
An Amphenol Company

# CSA certified, hermetic triaxial accelerometer

## 993B-7-33

### SPECIFICATIONS

<b>Sensitivity, <math>\pm 10\%</math>, 25° C</b>	100 mV/g
<b>Acceleration range</b>	40 g peak
<b>Amplitude nonlinearity</b>	1%
<b>Frequency response<sup>1</sup>:</b>	
<b>Z axis, <math>\pm 3</math> dB</b>	2 - 10,000 Hz
<b>X and Y axes, <math>\pm 3</math> dB</b>	2 - 7,000 Hz
<b>Transverse sensitivity, max</b>	7% of axial
<b>Power requirement:</b>	
<b>Voltage source</b>	18 - 30 VDC
<b>Current regulating diode</b>	2 - 5 mA
<b>Electrical noise, equiv. g, nominal:</b>	
<b>Broadband 2.5 Hz to 25 kHz</b>	160 $\mu$ g
<b>Spectral 10 Hz</b>	10 $\mu$ g/ $\sqrt{\text{Hz}}$
<b>100 Hz</b>	1.4 $\mu$ g/ $\sqrt{\text{Hz}}$
<b>1,000 Hz</b>	1.0 $\mu$ g/ $\sqrt{\text{Hz}}$
<b>Output impedance, max</b>	400 $\Omega$
<b>Bias output voltage, nominal</b>	11 VDC
<b>Grounding</b>	case isolated, internally shielded
<b>Turn-on time</b>	<1 sec
<b>Temperature range</b>	-50 to +120° C
<b>Vibration limit</b>	500 g peak
<b>Shock limit</b>	5,000 g peak
<b>Electromagnetic sensitivity, equiv. g</b>	100 $\mu$ g/gauss
<b>Sealing</b>	hermetic
<b>Base strain sensitivity, max</b>	0.0005 g/ $\mu$ strain
<b>Hydrostatic pressure, max</b>	100 psi
<b>Weight (excluding cable)</b>	134 grams
<b>Case material</b>	316L stainless steel
<b>Cable material</b>	integral, 16 ft, gray, 3 pair, individually shielded
<b>Mounting</b>	1/4-28 captive screw

### Contact

Wilcoxon Sensing Technologies

20511 Seneca Meadows Parkway  
Germantown MD 20876, USA

Tel: +1 301 330 8811  
Fax: +1 301 330 8873

info@wilcoxon.com

www.wilcoxon.com

### Accessories supplied:

- Calibration data
- 1/4-28 captive screw

**Options:** 10-32 captive screw; M6-1 captive screw; cable length and connectors

Note: Due to continuous process improvement, specifications are subject to change without notice.  
This document is cleared for public release.

Wilcoxon Sensing Technologies  
20511 Seneca Meadows Parkway  
Germantown, MD 20876  
info@wilcoxon.com

Tel: (301) 330 8811  
Fax: (301) 330 8873  
www.wilcoxon.com

**Wilcoxon Sensing Technologies**  
An Amphenol Company