

L1320

Emergency Lighting Equipment For Use In Hazardous Locations

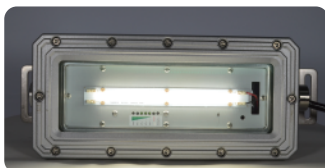

Protection

- Class I, Division 1, Group B, C and D
- Class II, Division 1, Groups E, F and G

Standards

UL 844
UL 924
CSA C22.2 NO. 137
CSA C22.2 NO. 141-15

Light Features

- Rugged design
- Provides up to 90 mins. Emergency lighting
- "Always illuminates" type available

Net Weight: 5.0 kg (11.0 lb)

Technical Data

Rated Voltage (±10%)	100-277V AC						
Total System Power Consumption	30W						
Emergency Run Time	90 minutes						
Recharge Time / Output LED Wattage	48 hours / 20W						
Battery Type	Ni-MH Battery						
CCT	3000K / 5000K						
CRI	Cool White ≥ 70 / Warm White ≥ 80						
Lumen (±10%)	<table> <tr> <td></td><td>20W</td></tr> <tr> <td>3000K</td><td>1900lm</td></tr> <tr> <td>5000K</td><td>2000lm</td></tr> </table>		20W	3000K	1900lm	5000K	2000lm
	20W						
3000K	1900lm						
5000K	2000lm						
Ambient Temperature	CID1: 0°C ~ +40°C, T6 / CIID1: +40°C, T4A						
Power Factor	cos ≥ 0.9						
Beam Angle	X-110° / Y-110°						
Frequency	50 / 60 Hz						
Degree of Protection	IP67 / NEMA 6						
Material	<ul style="list-style-type: none"> • Enclosure: Aluminum alloy • Glass: Tempered glass 						
LED Service Life	60,000 hrs						
Entrance Thread	NPT 3/4"						

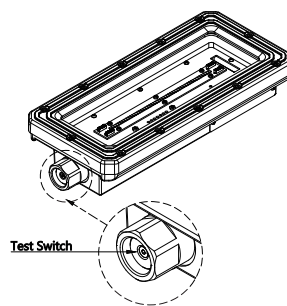
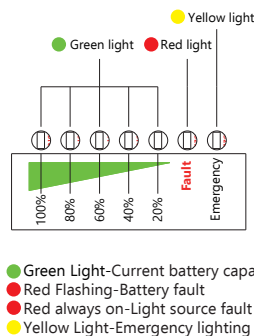
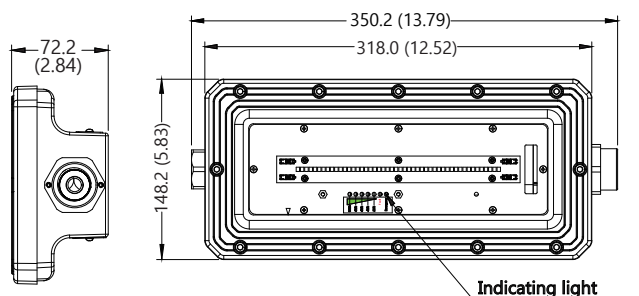

Dimension in Millimeters (inches)

Model Code

THT

E

1320

C

N

H

C

A

B0

C90

①

②

① C.C.T.

C=Cool White

W=Warm White

② Mounting Bracket Type

WAD=Wall mount A type

W00=Wall mount B type

HAD=Hanging mount

C90=Ceiling

Mounting Option & Dimensions (All in mm)

Wall Mount - Type A (WAD)

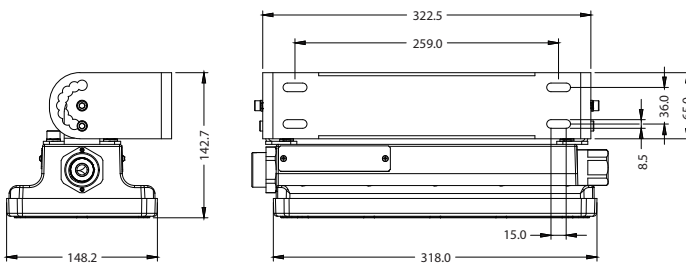

6.1 kg (13.4 lb)

Hanging Mount (HAD)

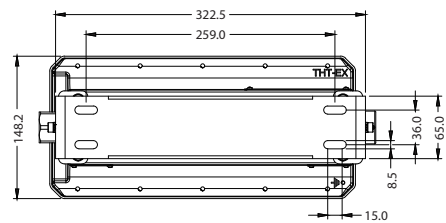

Wall Mount - Type B (W00)

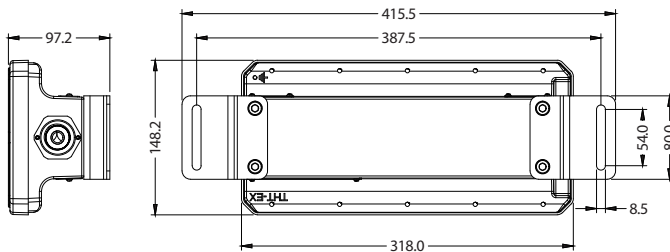

5.2 kg (11.4 lb)

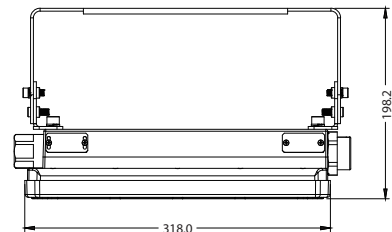

6.1 kg (13.4 lb)

Ceiling (C90)

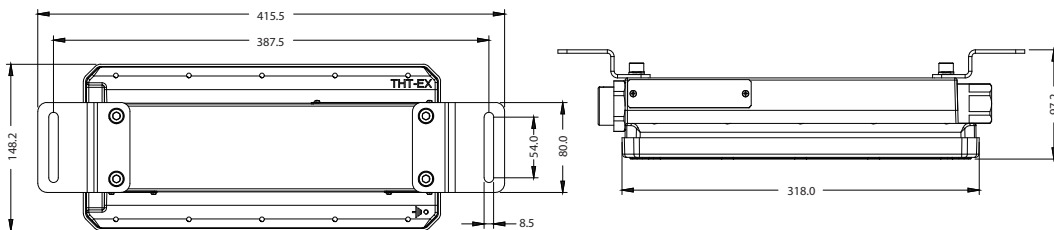

5.2 kg (11.4 lb)

Applicable Area

- Oil Refinery Complex
- Painting Facility
- Transporting Liquefied
- Offshore Platform
- Petrochemical Complex
- Transporting Nature Gas
- Petroleum Gas
- (Oil and Natural Gas)