

L1320

Emergency Lighting

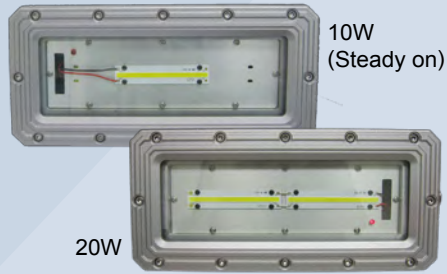

Net Weight: 5kg



Standard Product

Dimensions and Mounting (Mounting Code)

Wall Mount - Type A (WAD)

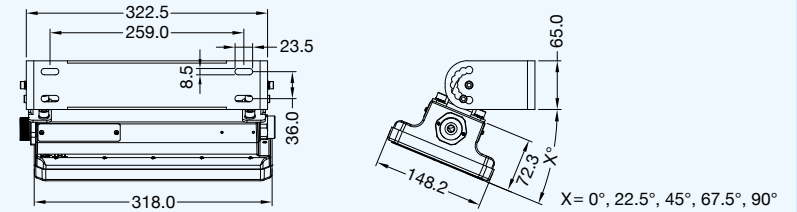

Wall Mount - Type B (W00)

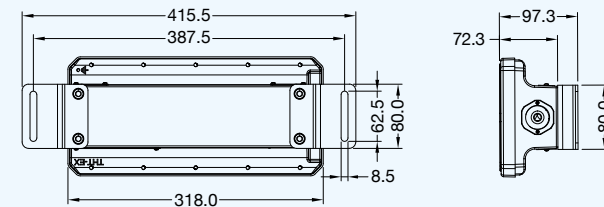

Hanging Mount (HAD)

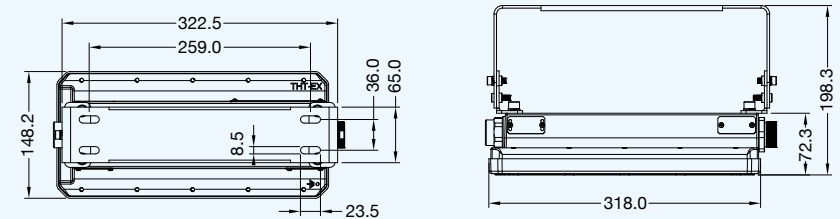

Ceiling (C90)

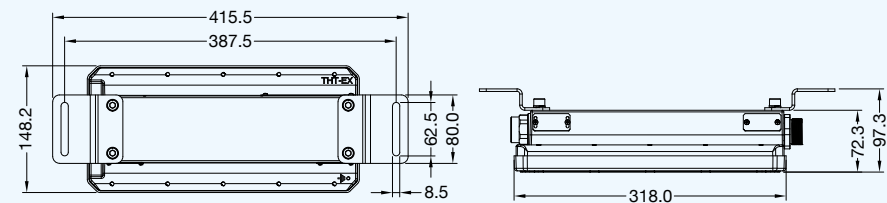

► Please refer to Page 95 for part number

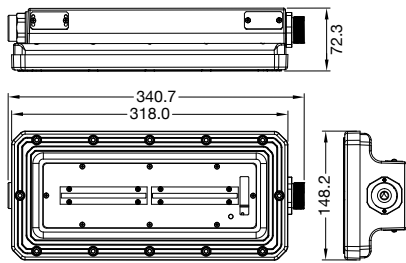

Dimension in Millimeters

Applicable Location

- Zone 1
- Zone 2
- Zone 21
- Zone 22

Environmental Ratings

- NEMA 6/6P
- IP 67/68

Applicable Area

- Oil Refinery Complex
- Petrochemical Complex
- Painting Facility
- Transporting Natural Gas
- Transporting Liquefied Petroleum Gas
- Offshore Platform (Oil and Natural Gas)

Electrical Ratings





Voltage	110V / 220V AC
Wattage	10W (Steady on) / 20W
Lighting time	Over 90 minutes
Charging Time	48 hours
Battery Type	NiMH batteries

Raw Materials

Housing	Aluminum Alloy
Screws	Stainless Steel
Tempered Glass	IEC Standards impact-resistant > 4 Joule

Part Number

• W.W.: 3000K±10% • C.W.: 5000K±10%

Model No.	Certifications	Watt.	Volt.	Color	Part Number	
L1219B	 Ex d IIB + H ₂ T5...T4 Gb Ex tb IIIC T90°C...T105°C	50W Tall top Cover	110V	W,W,	THT-EX1219WCCA51	
			220V	W.W.	THT-EX1219WECA51	
			110V	C.W.	THT-EX1219CCCA51	
			220V	C.W.	THT-EX1219CECA51	
	 II 2 G Ex d IIB + H ₂ T5... T4 Gb; II 2 D Ex tb IIIC T90°C...105°C Db	50W Short top Cover	110V	W.W.	THT-EX1219WCCB51	
			220V	W.W.	THT-EX1219WECB51	
			110V	C.W.	THT-EX1219CCCB51	
			220V	C.W.	THT-EX1219CECB51	
	 Ex d IIB + H ₂ T5...T4 Gb DIP A21 T _A 90°C...105°C	60W 70W 80W Tall top Cover	110V	W.W.	THT-EX1219WCCA5A	
			220V	W.W.	THT-EX1219WECA5A	
			110V	C.W.	THT-EX1219CCCA5A	
			220V	C.W.	THT-EX1219CECA5A	
	 Ex d IIB + H ₂ T5 Gb Ex tb IIIC T135°C Db	50W	220V	W.W.	THT-2LA50Wd52W1219	
				C.W.	THT-2LA50Wd52C1219	
		60W	220V	W.W.	THT-2LA60Wd52W1219	
				C.W.	THT-2LA60Wd52C1219	
		70W	220V	W.W.	THT-2LA70Wd52W1219	
				C.W.	THT-2LA70Wd52C1219	
		80W	220V	W.W.	THT-2LA80Wd52W1219	
				C.W.	THT-2LA80Wd52C1219	
L1320		 Ex d IIC T6 Gb Ex tb IIIC T85°C Db	10W Steady on	110V 220V	C.W.	THTE1320ANCCAA0
			20W	110V 220V	C.W.	THTE1320ZNCCAB0

Ordering information: Part number + mounting code